

**local aspects \* notes**

- / Morava river
- / flood-plain biotopes
- / torso of destroyed telpher line
- / proximity of cyclo route, road
- / isolation in preserved zone
- / often floods inhibit classic forms of construction

- / close settlements offer all kinds of services
- / high frequency of one-shot visitors (cyclists, visitors of surrounding monuments)
- / a need for providing special experience
- / history (Sandberg, Devin castle, Schlosshoff castle, fossils,...)

**proposal \*notes**

1. we chose space instead of volume
2. - a space, created by a strip wounded around pylons
3. - a space that has qualities of shakespeare theatre. A stage is surrounded by history of pylons, which support the footbridge with its

variable future presence of audience.

4. - a platform for cultural events, concerts, holy masses
5. pylons are completely exposed to visitors - they are relics by themselves.
- + They can be simultaneously used as pedestals for statues (...).
6. river is a still present doomsday machine with

power to reset the status quo of whole area.

- former border between two states
- present border between two banks
- a line communication, able to connect great distances
- a border in time, every year threatens the area with floods. once by time "explodes".
- a force, that bit a piece of sandberg - by a

means of granting opportunity to transport its mass.

7. a pit-stop for cyclists - the highest rate of use would be probably in summer, or autumn with good weather. or in spring, to watch the bustling river.
8. accessibility for disabled

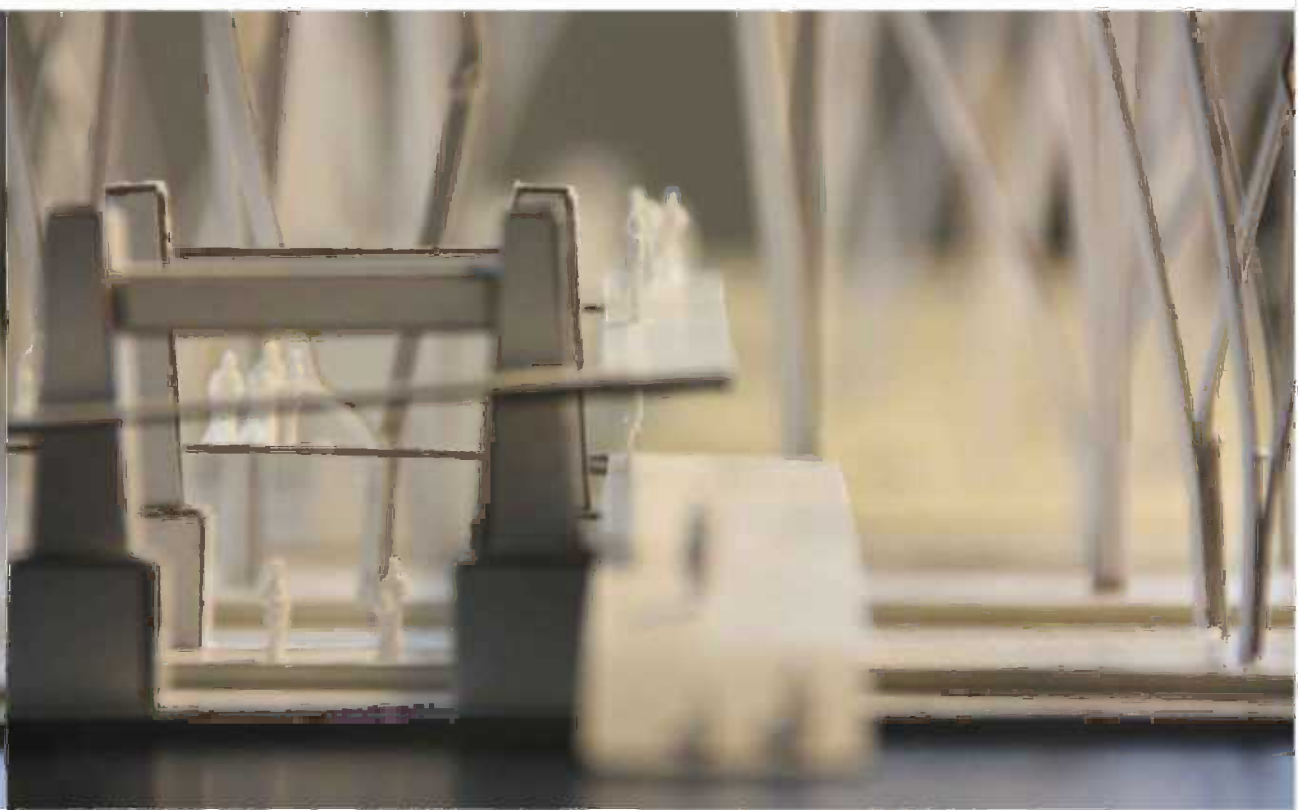
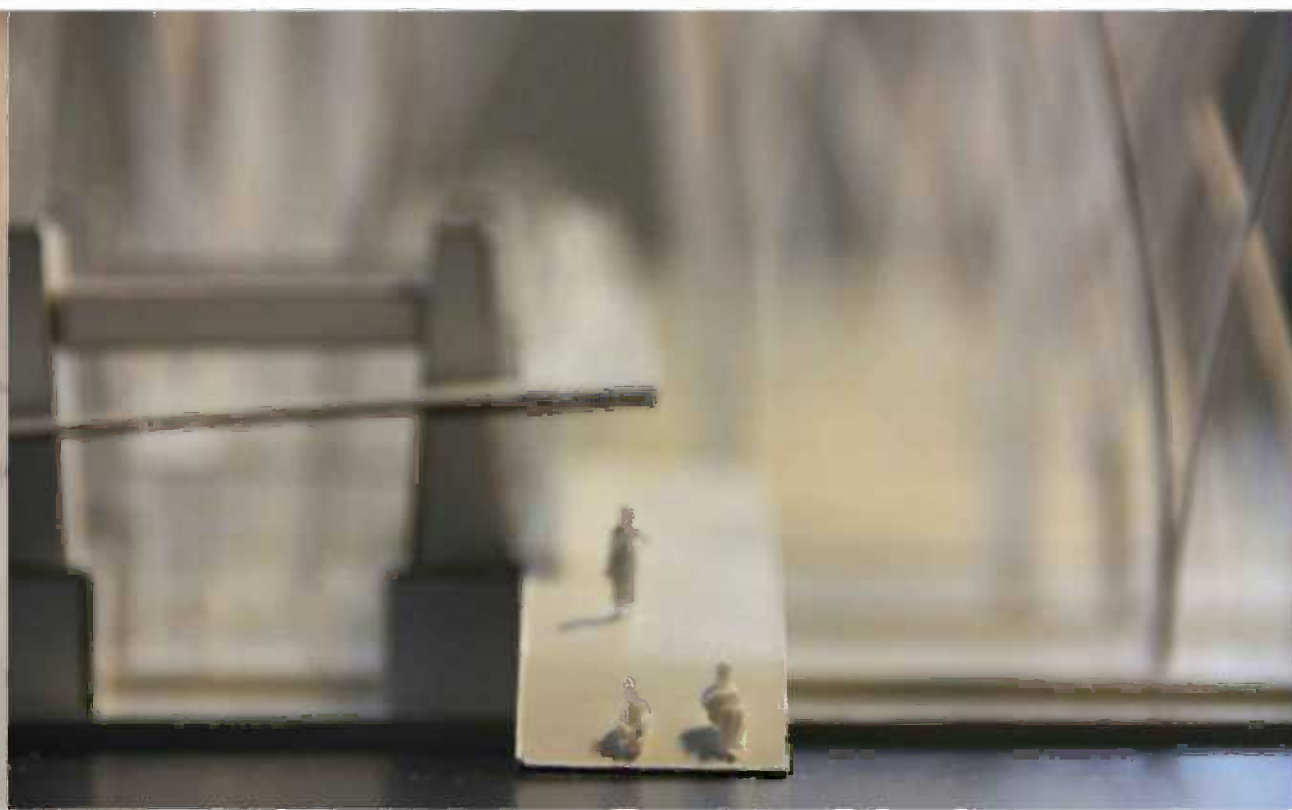
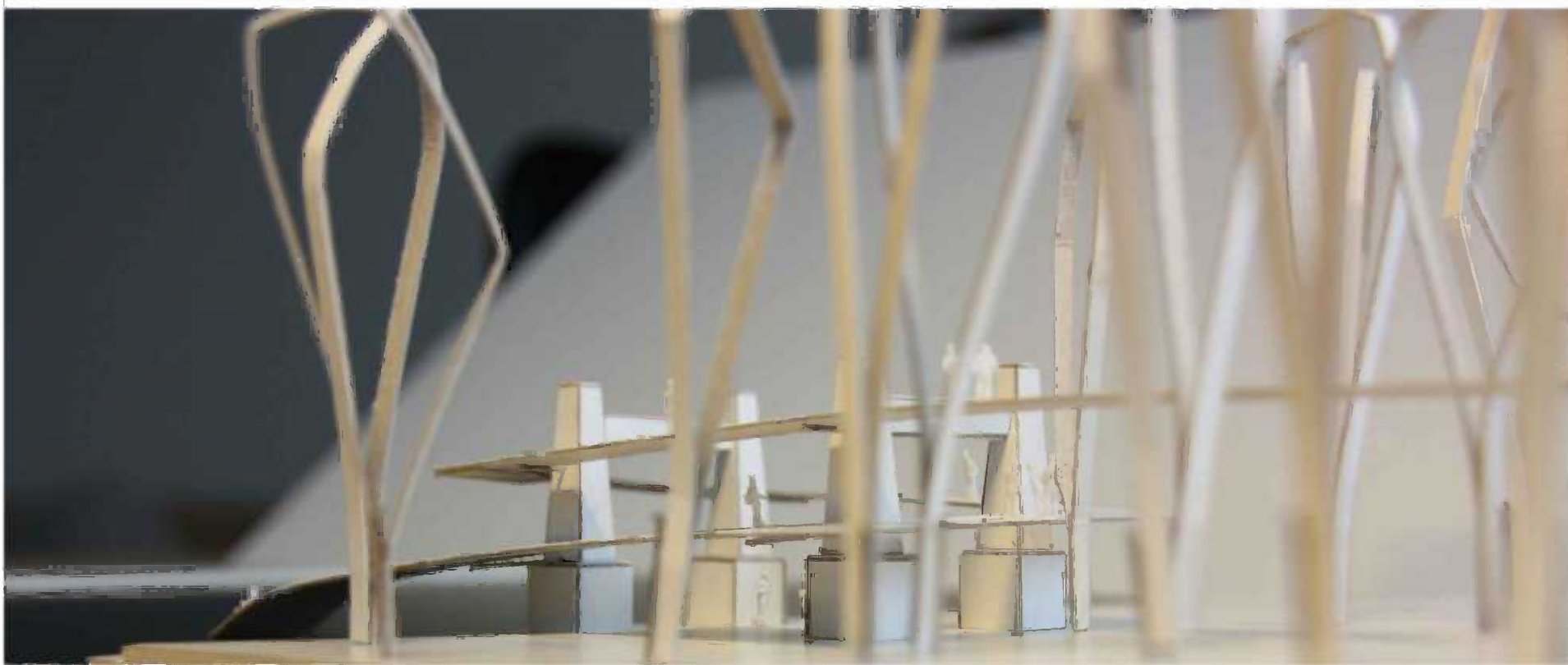
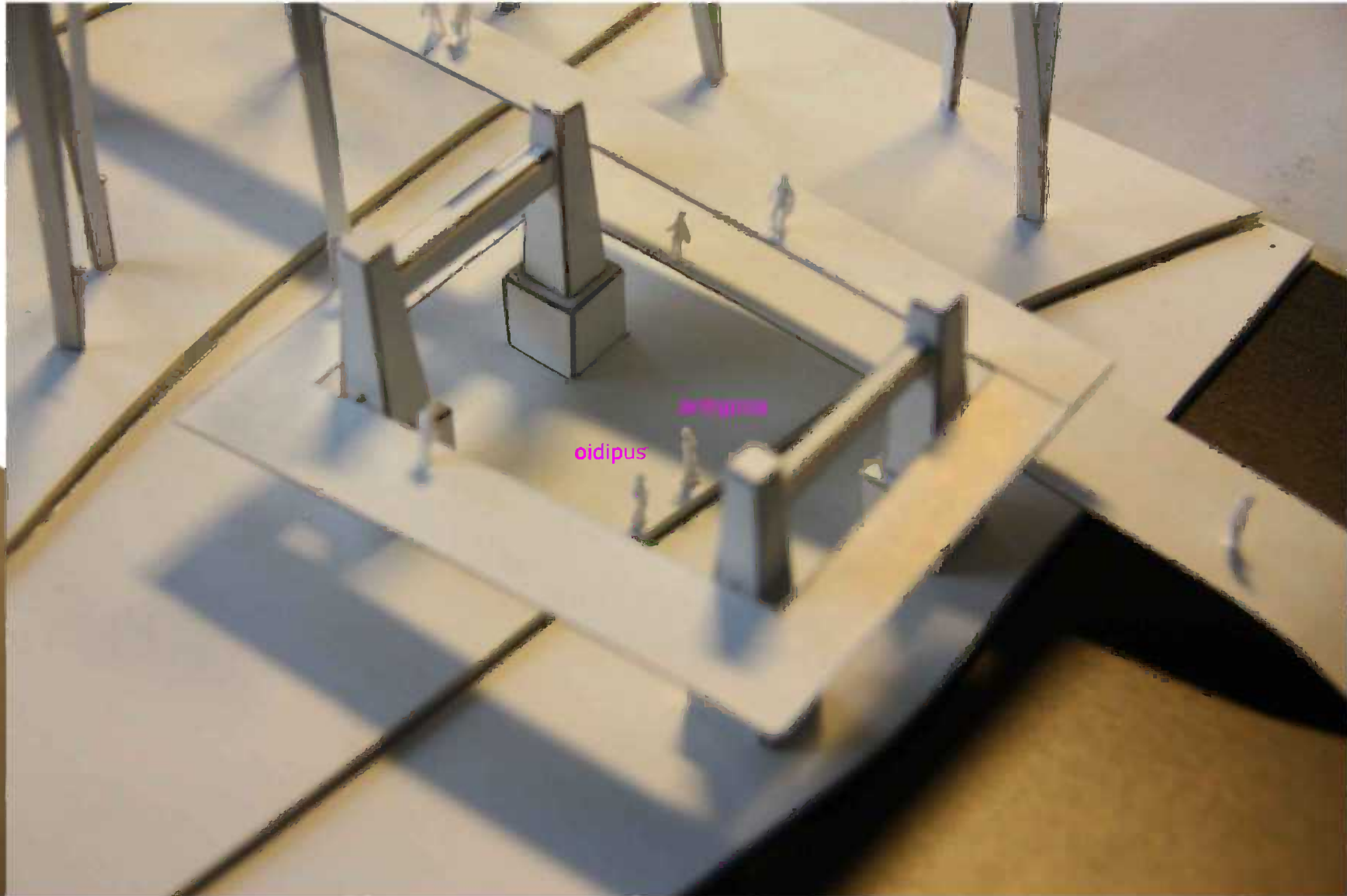
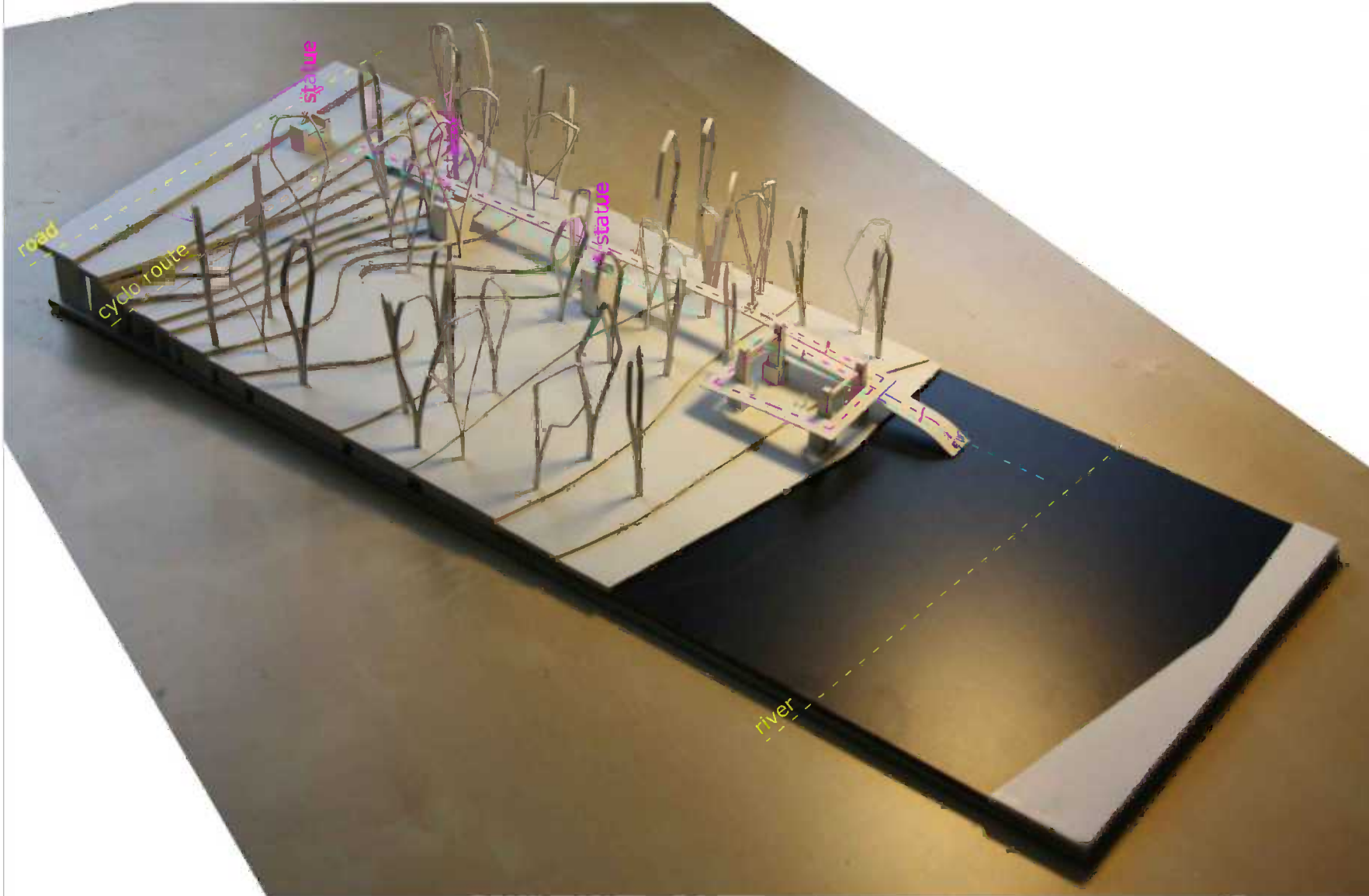

siteplan 1/500

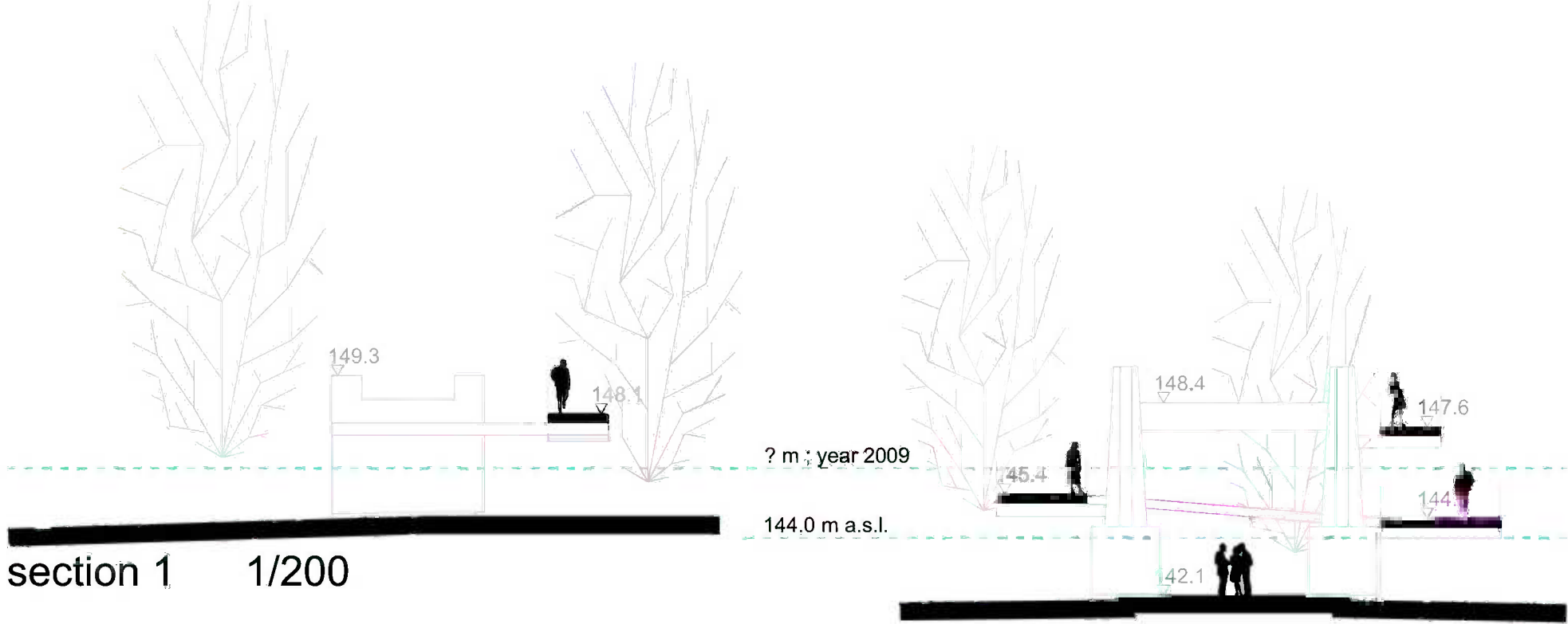

section 1 1/200

section 2 1/200

**construction \*notes**

- horizontal decks on the inner perimeter create a pleasant conditions for standing (audience)
- all sections in slope 1/12 are shorter than 9 metres
- corner sections are almost horizontal (less than 1/20)

**materials**

- footbridge: steel construction
- decking: rotproof hard wood
- railing: steel tube + steel netting (big mesh)

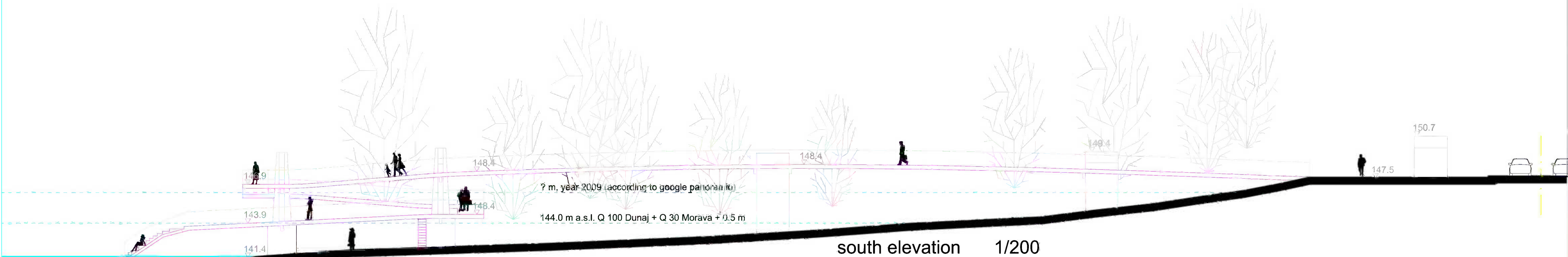

south elevation 1/200