

sandberg platform

Xella - meetingpoint 4 sandberg

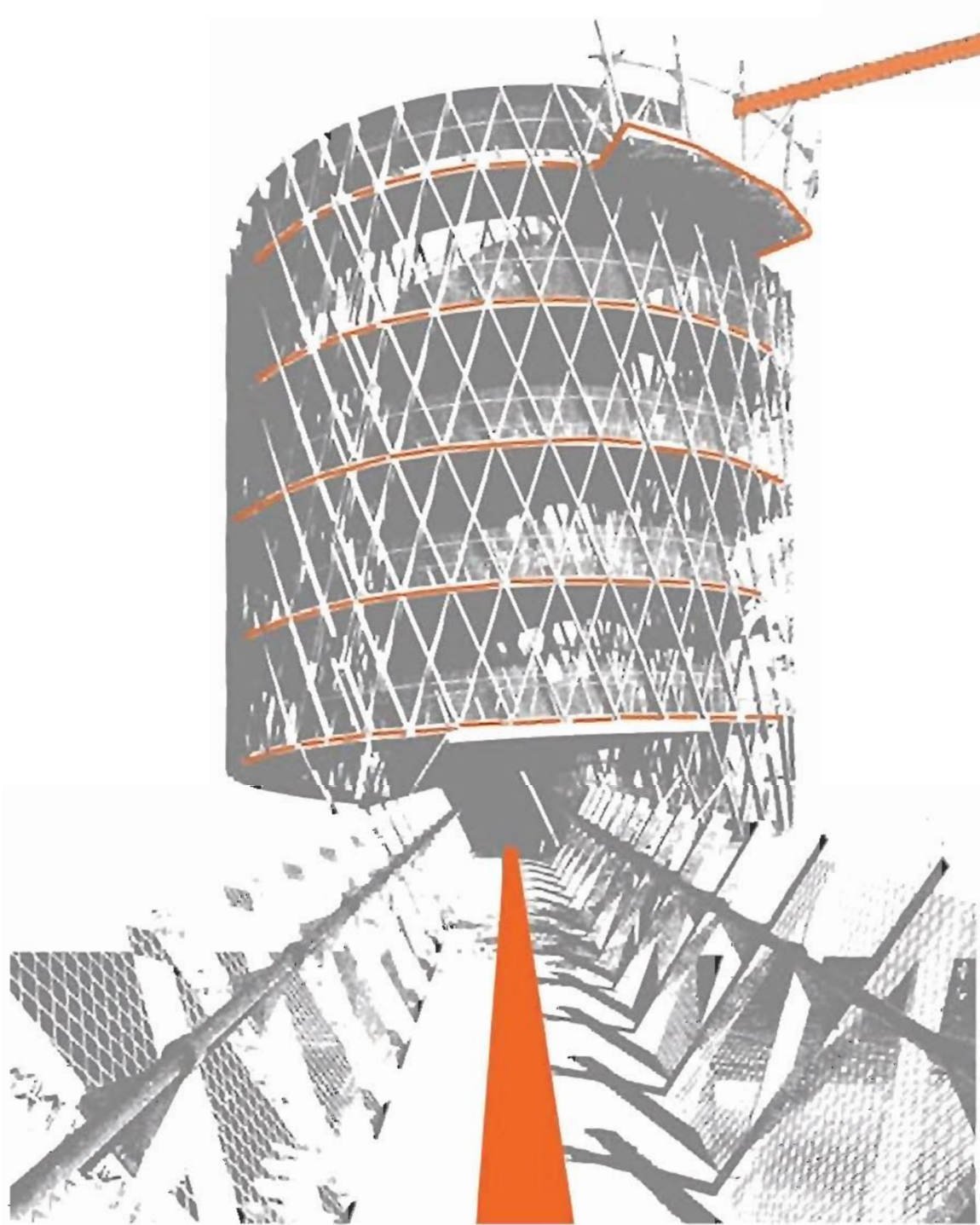

perspective view

The environment of the development area is a nature made cathedral. Each tree and each shrub could be the place for meeting with friends, foreigners or with our selfs. Just stand on a stone and you will never be alone under the „Cope of heaven“ made of sand.(Sandberg)

This project provides a simple idea of lookout tower (sandberg platform) which stands on 4 former pylons, connected by a bridge fixed on the other 2 pylons. We can take it for a „time machine“ which is taking us with the dark internal ramp in to the world as it was millions years ago. Taking us from the place of present civilization problems to the time when all this area was on the bottom of the prehistoric see TETHYS. By the way down on the external ramp we can discover the Morava bank above the surface and slowly return to the present time

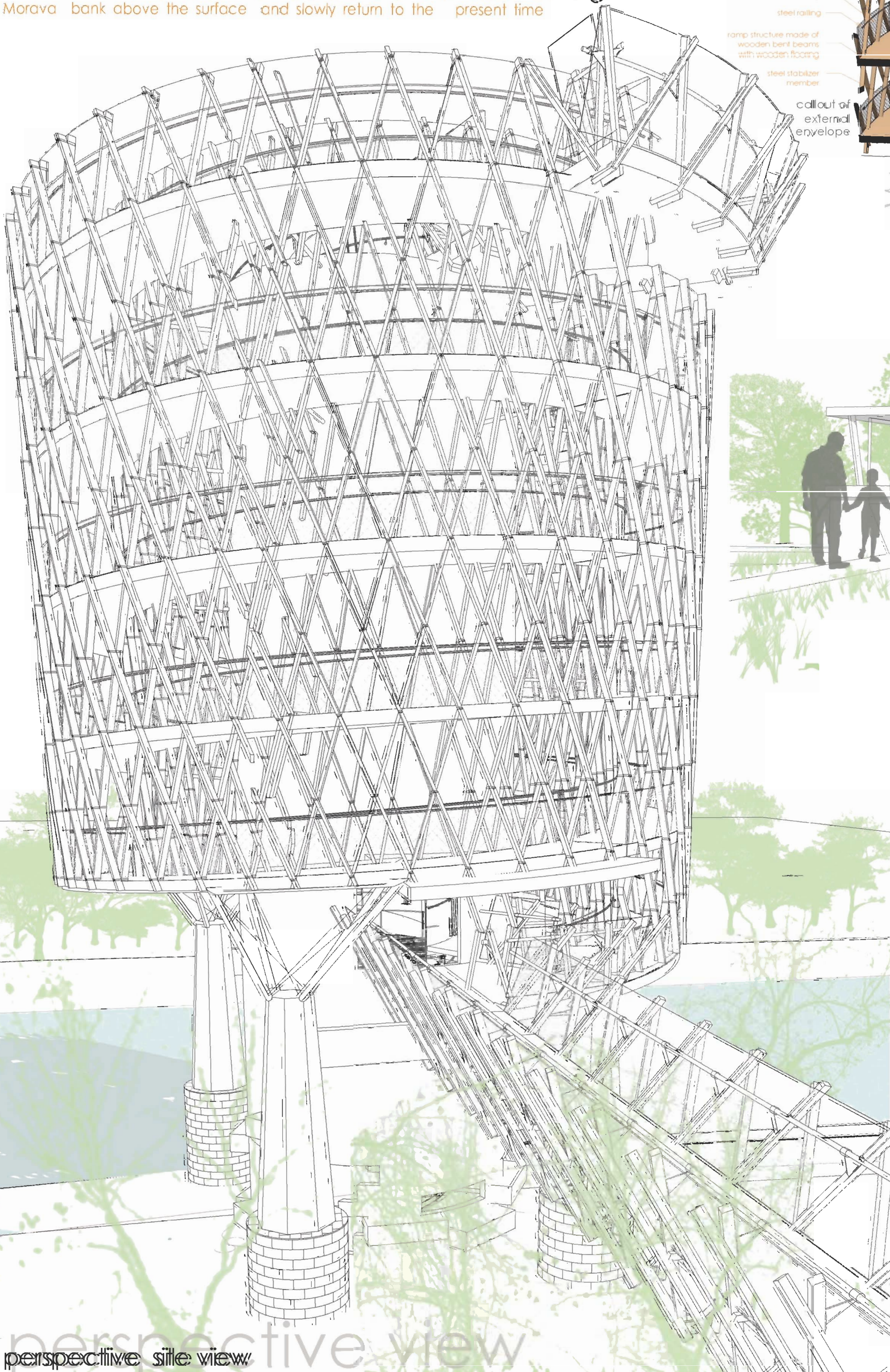

perspective view

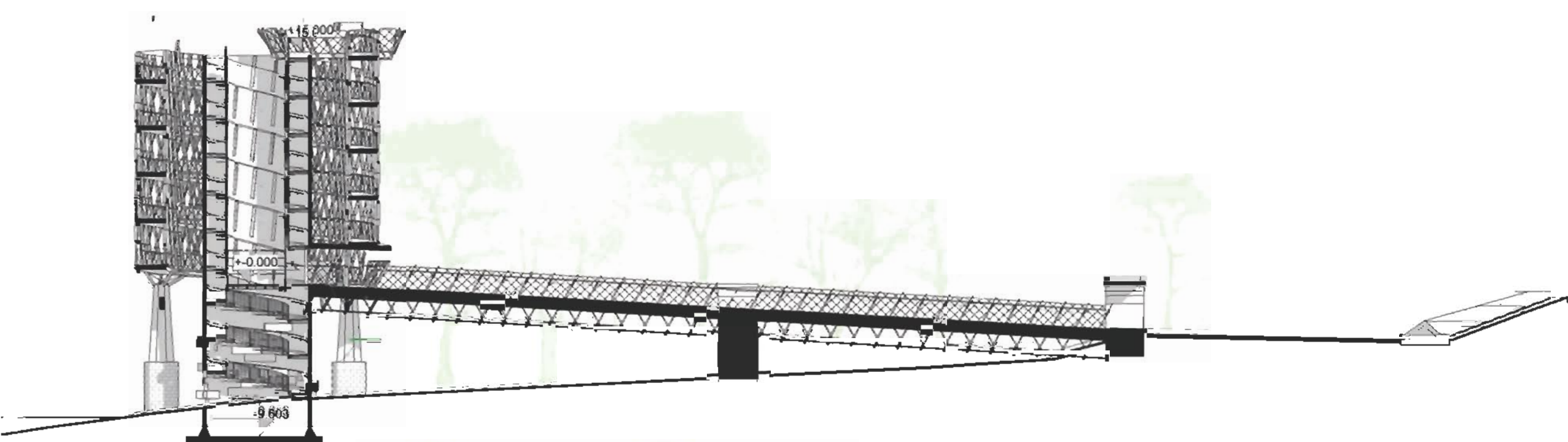

section

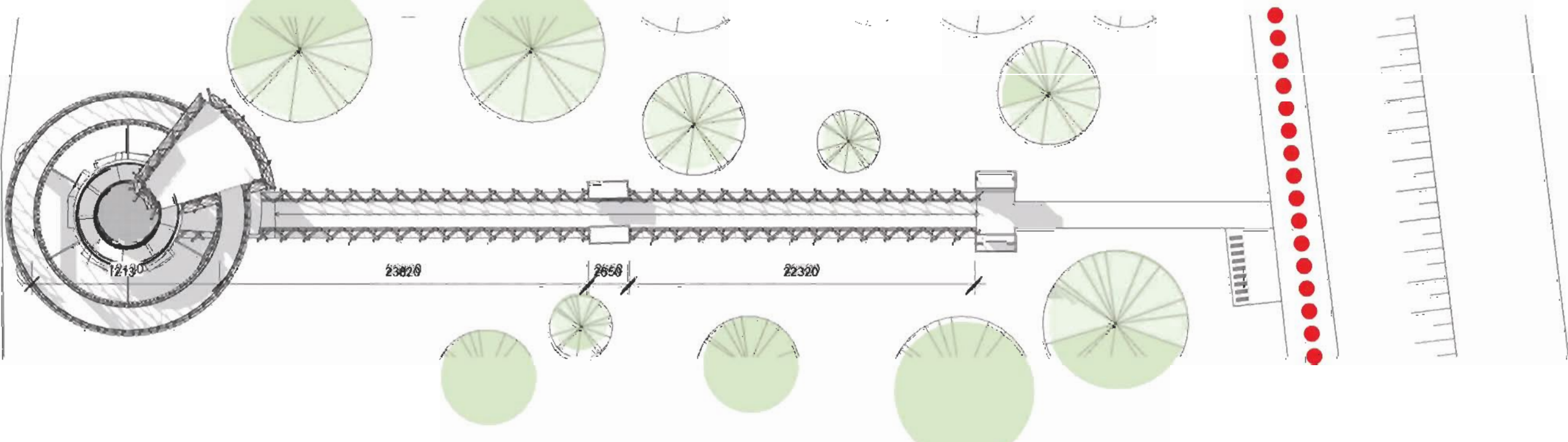

site plan

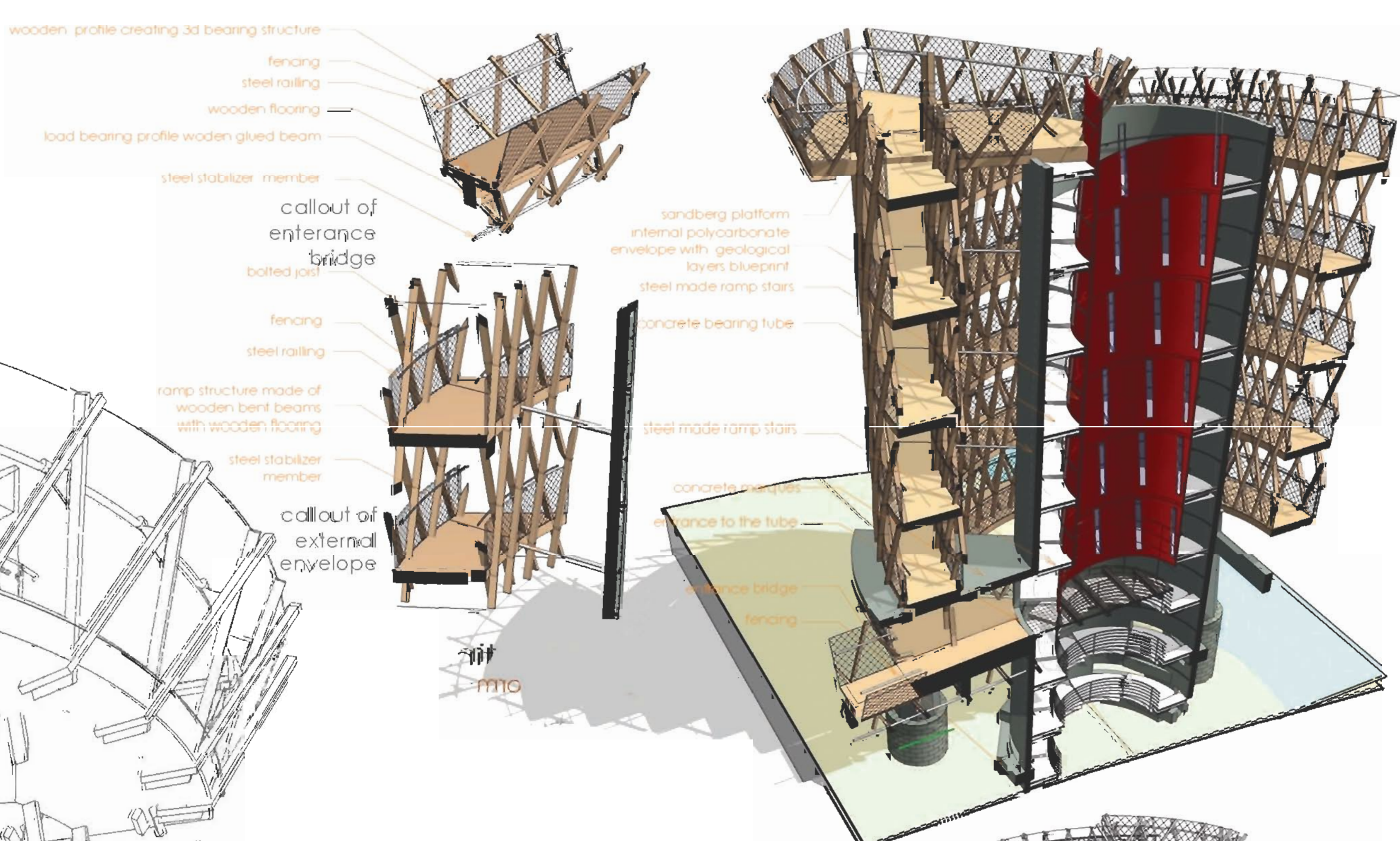

construction scheme



view from the cycle path

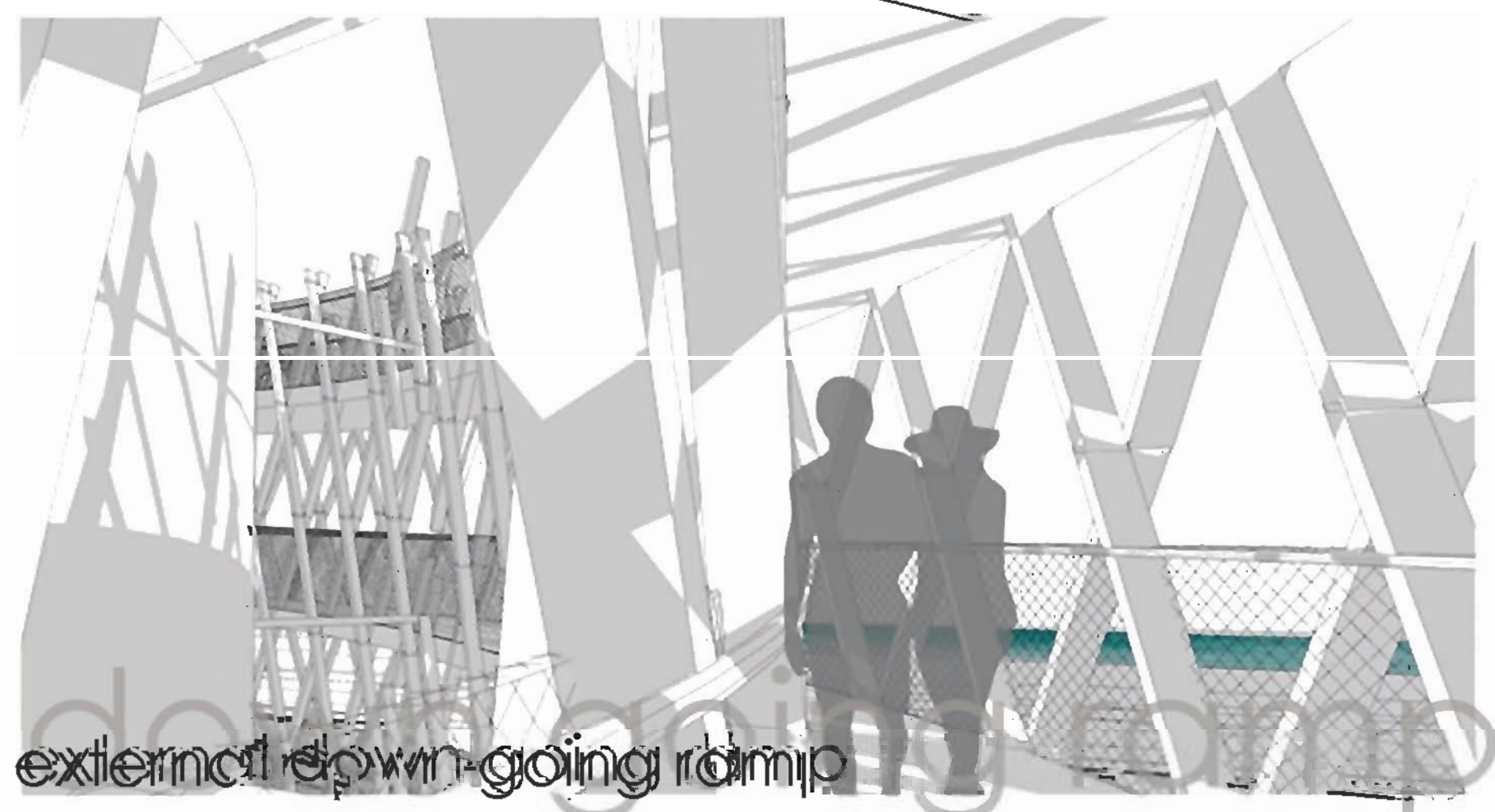

external down-going ramp

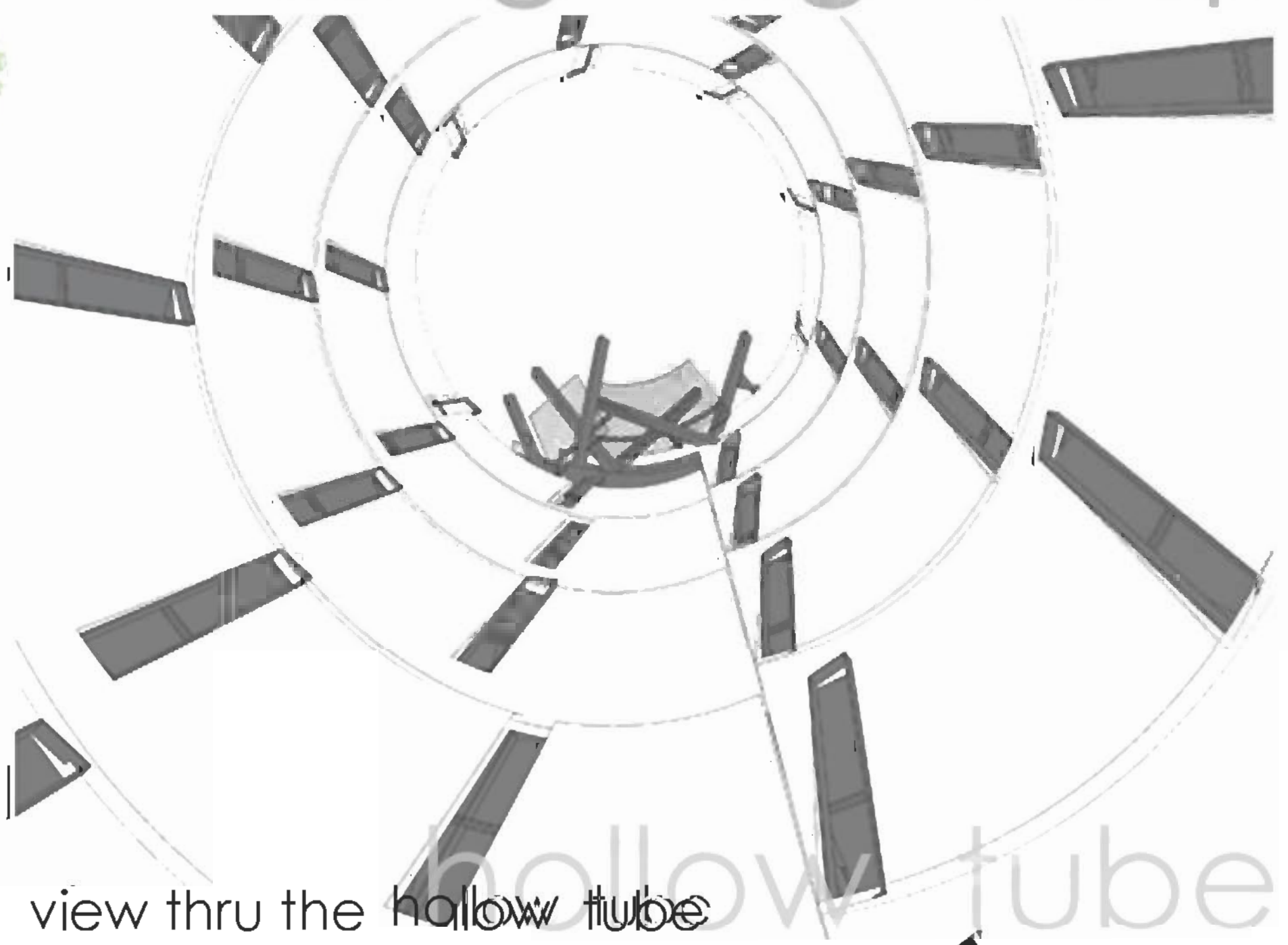

view thru the hollow tube

sandberg platform

Xella - meetingpoint 4 sannndberg

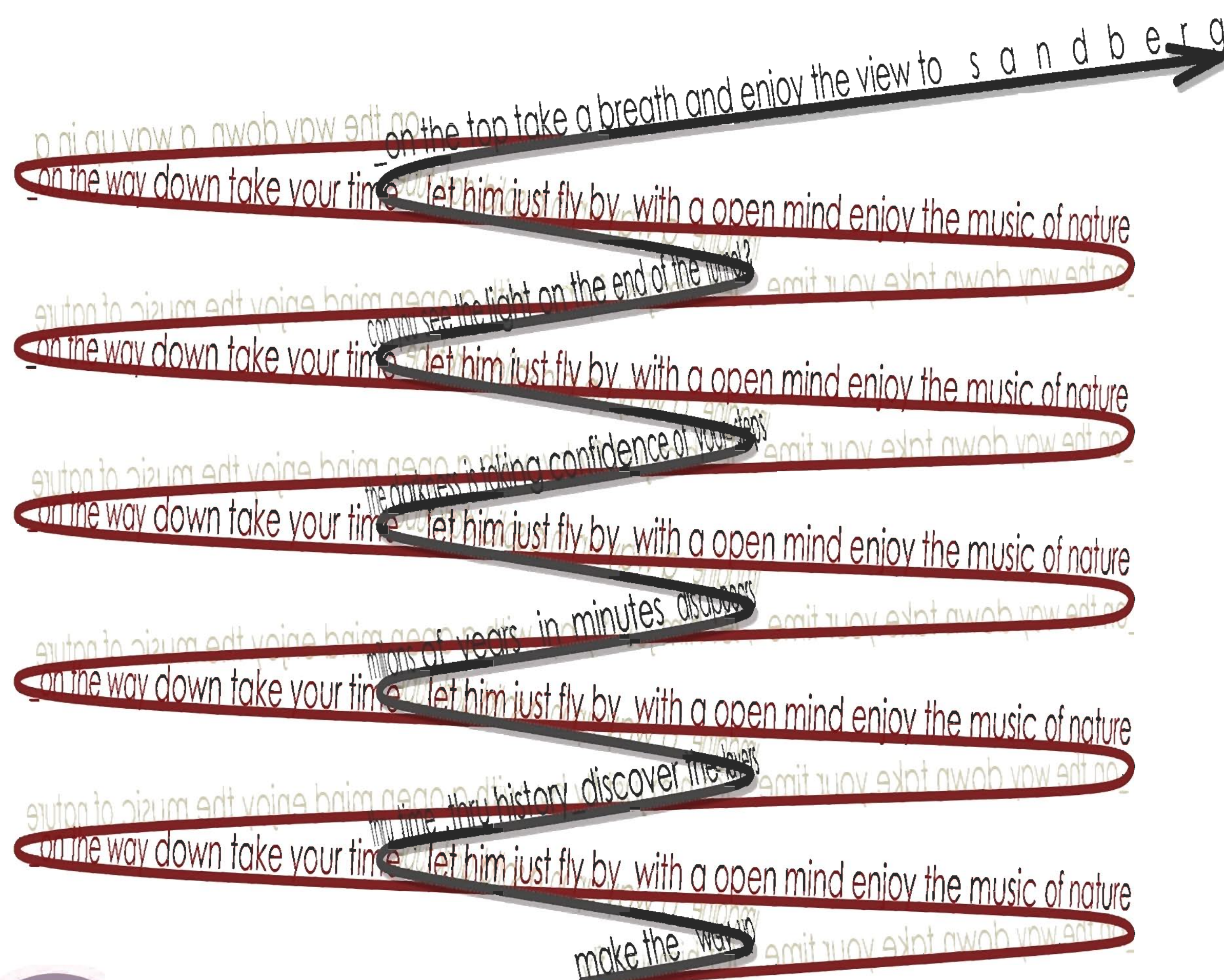

3 circles 3 meanings

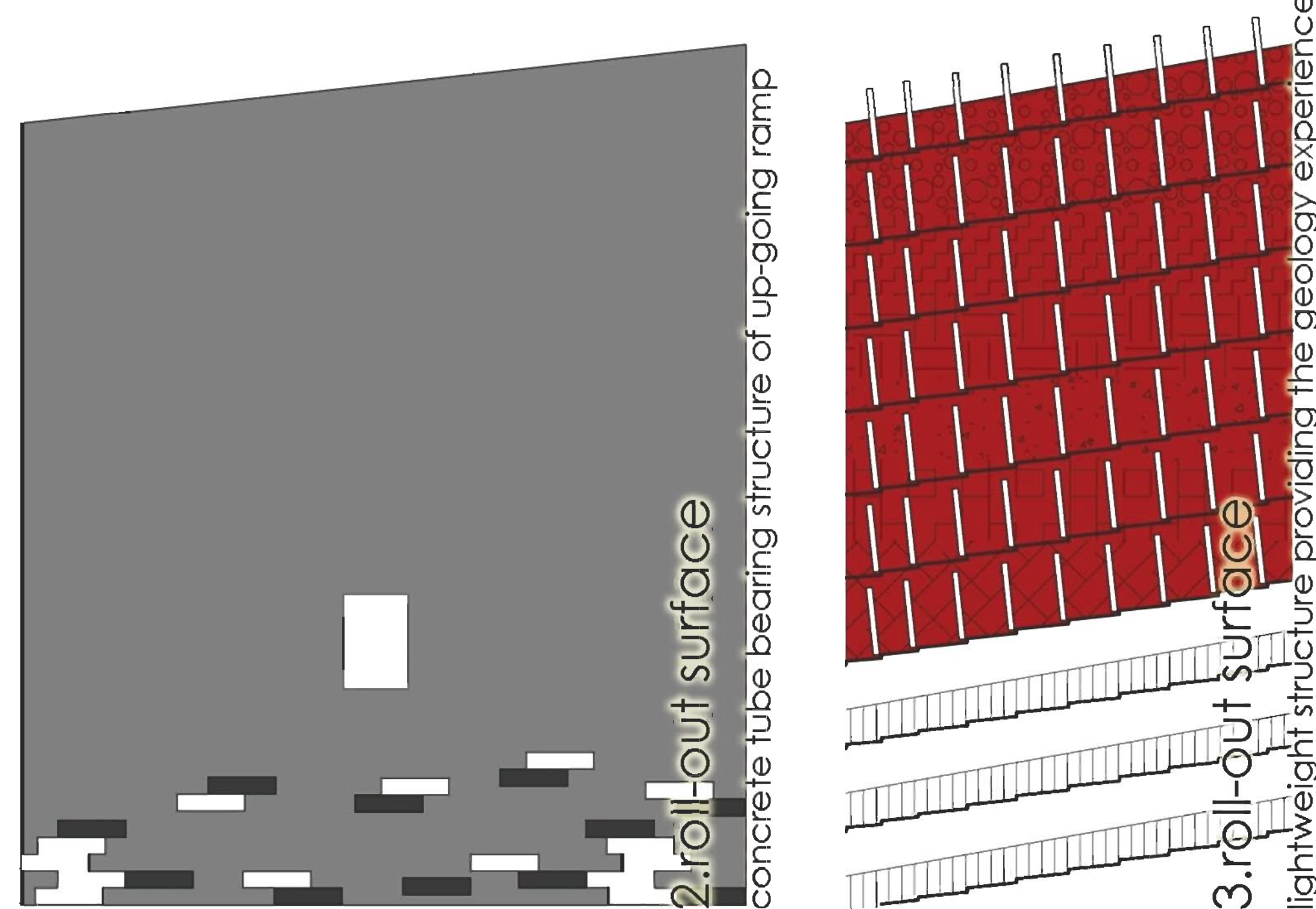
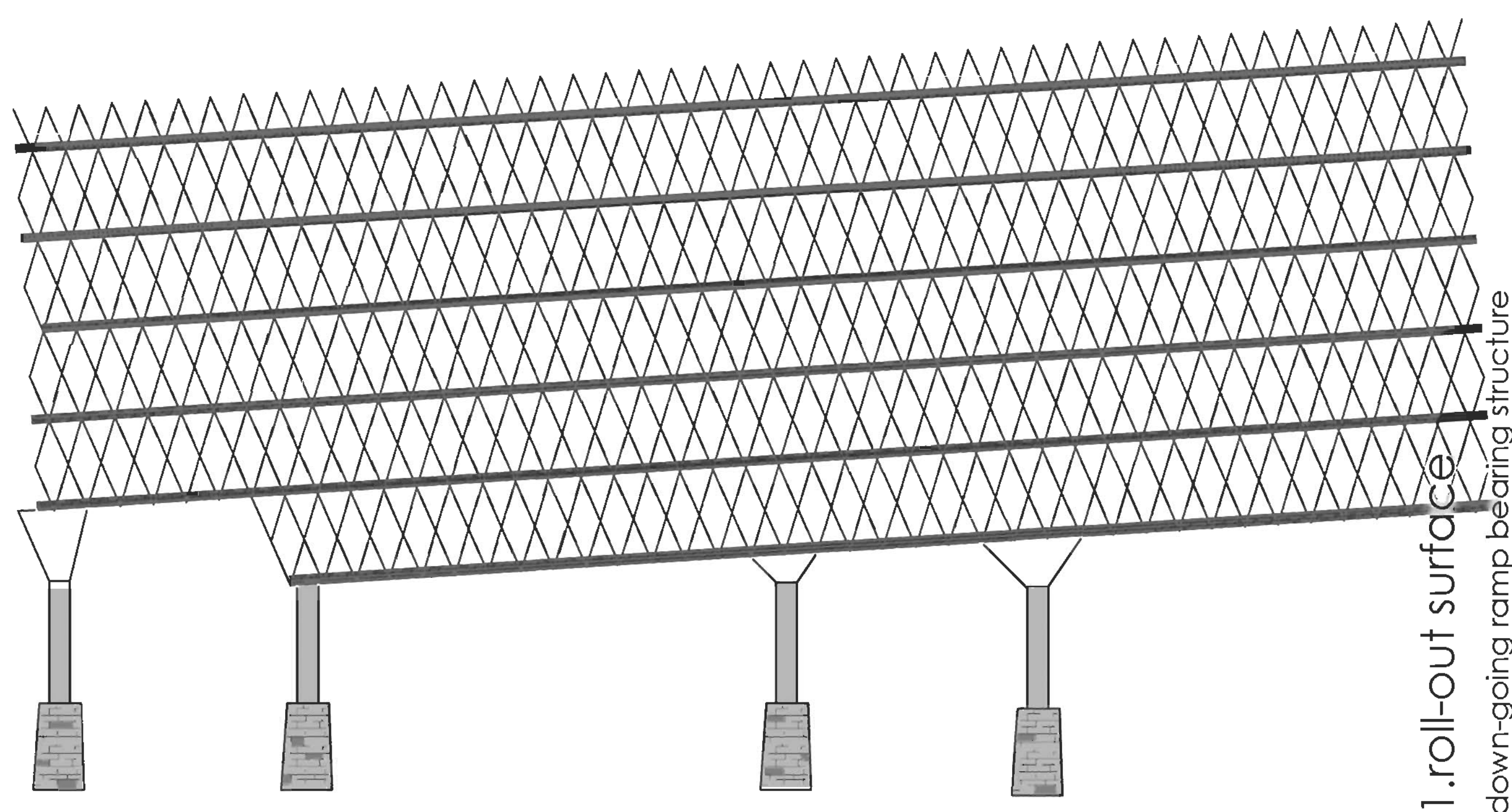
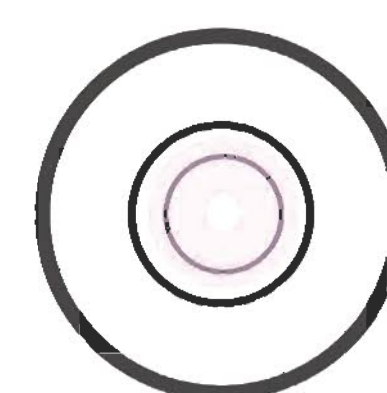
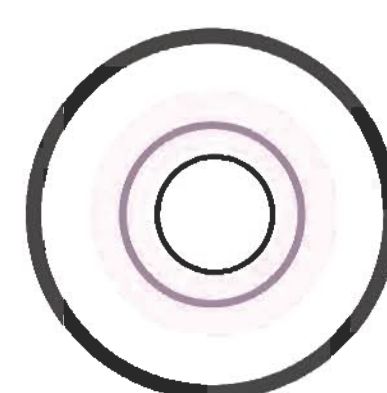
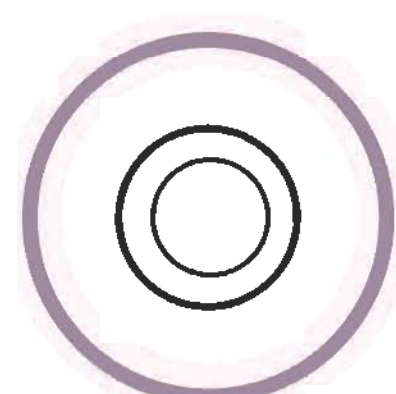

general layout of the site

general layout of the site

scale 1:3000

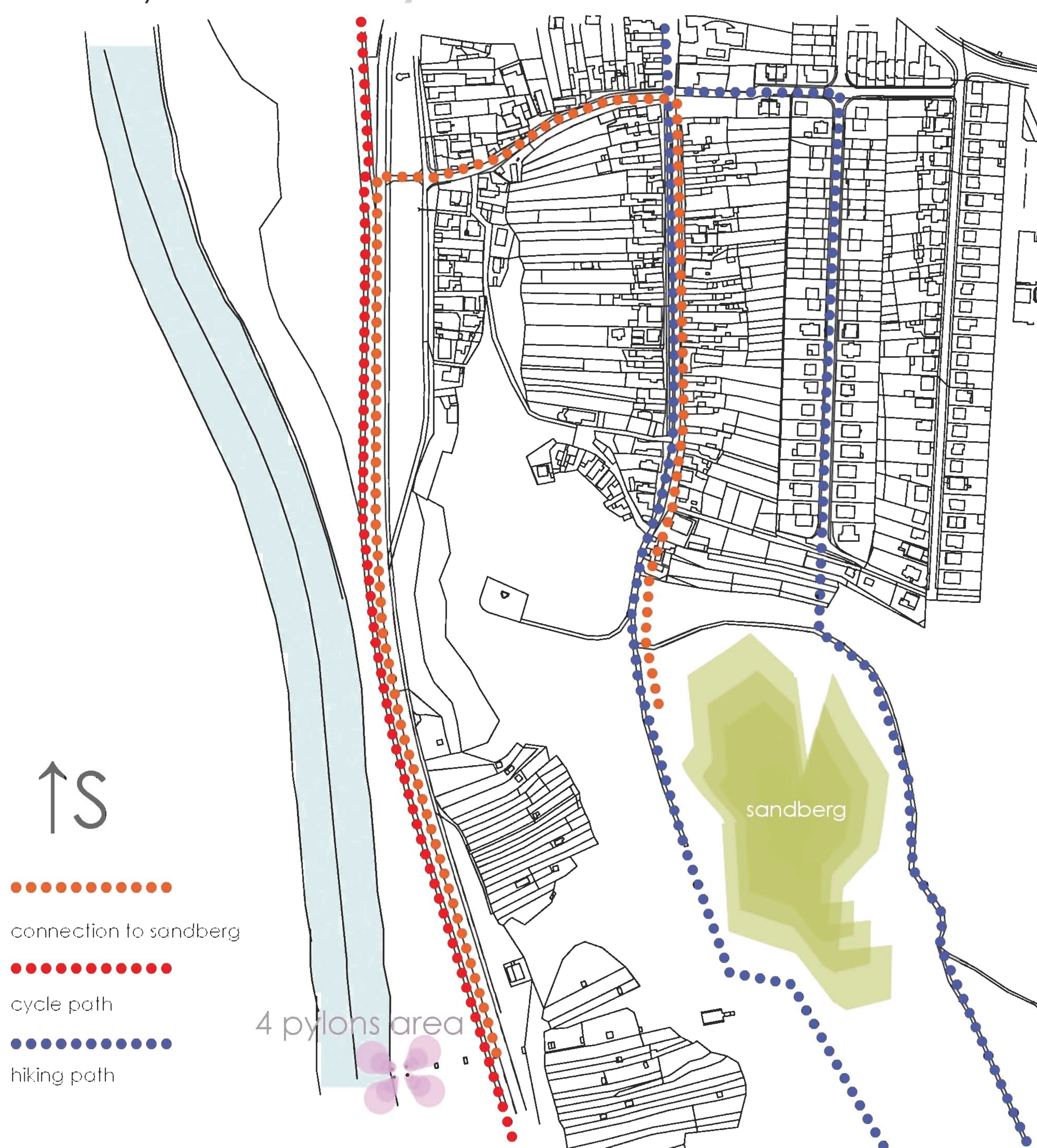

general layout of wider context

general layout of wider context

scale 1:10 000

