

MPAS

MEETING-POINT FOR SANDBERG

BRATISLAVA

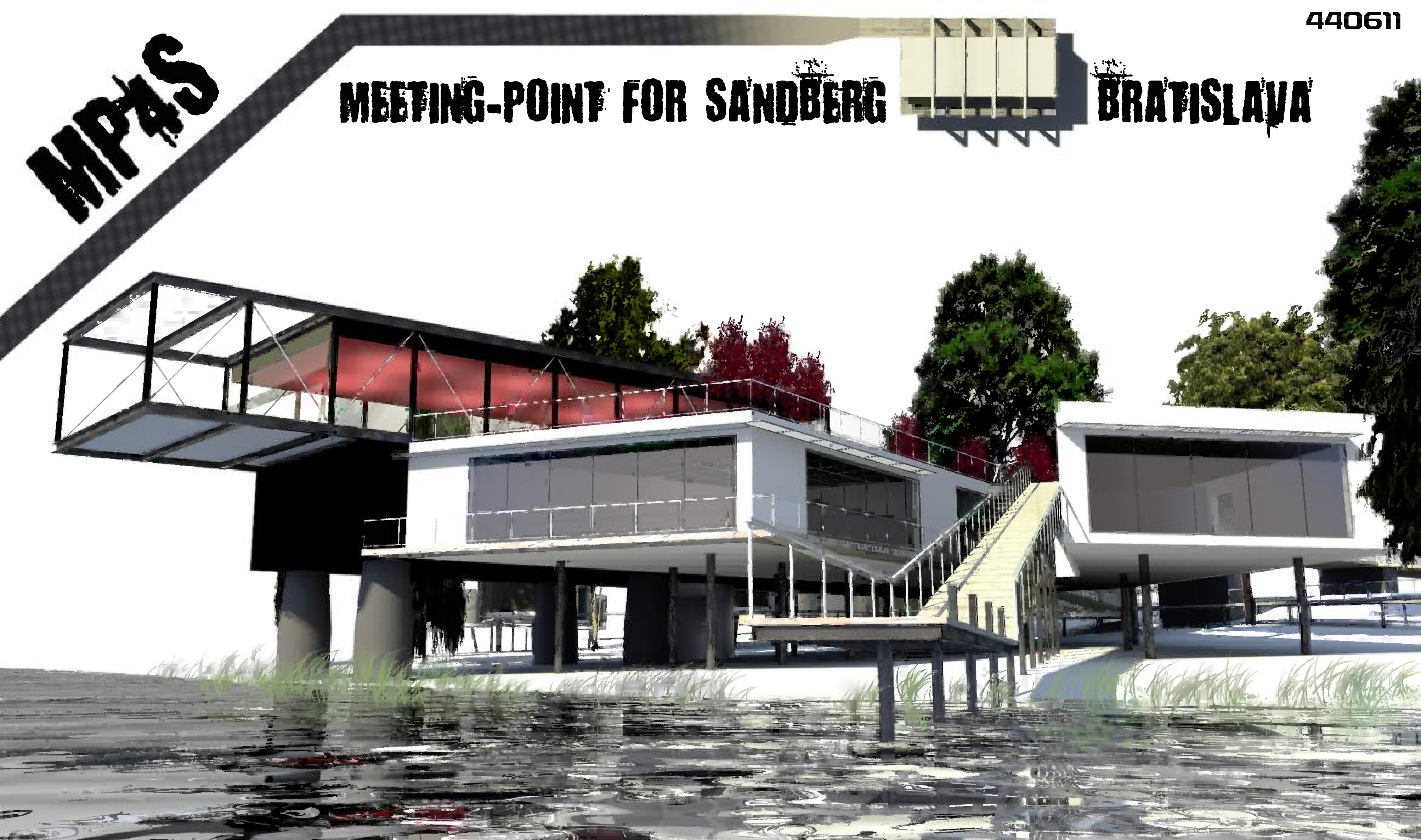

ALREADY IN THE PAST THIS AREA WAS REALLY IMPORTANT. SANDBERG, THE HILL, WHICH IS CLOSE TO THE DEVIN CASTLE, INCLUDES INSIDE A LOT OF OLD STONE BUILDINGS. THERE WERE ALSO SOME OLD CASTLES, BUT THEY WERE DESTROYED. DIGS, WHERE WERE FOUNDED TRILOBITES OR SPECIFIC FAUNA. BUT THE HILL IS NOT KNOWN JUST FOR THAT HISTORICAL AND NOWADAYS PRESERVE PARTS. THE HILL IS ACTUALLY DIG SANDSTONE AND THAT SANDSTONE WERE MINING UNTIL THE SECOND HALF OF TWENTIETH CENTURY. BECAUSE OF NEAR LOCATION TO THE RIVER MORAVA, THE SANDSTONE WAS USED TRANSPORTED BY FUNICULAR LIFT DOWN TO THE RIVER AND AFTER TO THE DRATISLAVA ON THE SPECIAL SHIPS, AND FROM THAT FUNICULAR WE CAN FIND ON OUR DESIGN AREA 4 CONCRETE PILLIONS AND OTHER CONCRETE BLOCOS ON THE OLD WAY OF FUNICULAR

OUR AREA IS PARTLY IN FLOOD LOCALITY, BUT BY USING 4 PILLONS, WE CAN DESIGN HERE A PLACE OF RELAX, MEDITATION OR A FUN. A MEETING PLACE OF DIFFERENT NATIONS AND CULTURES, OR PASSING PEOPLE BY THAT AREA AS

THERE ARE DESIGNED BUILDINGS IN TWO MAIN LEVELS. THE UPPER LEVEL IS SYMMETRICAL, WHICH COMES FROM THE MAIN AXIS OF THE ORIGIN FUNICULAR. THE LOWER LEVEL IS ASYMMETRICAL, WHICH COMES FROM THE MAIN AXIS OF THE PROPOSAL. IT IS DESIGNED IN THE INDUSTRIAL SHAPE, LIKE A LONG ST- FRAME, WHERE YOU COULD FIND A LUXURY COFFEE WITH A BALCONY ABOVE THE WATER AND THIS LEVEL HAS TWO LOWER PARTS TOO, WHERE IS SITUATED THE GARDEN AND THE GARDEN WITH THE GARDEN. THE LOWER LEVEL IS BASEMENTS FOR THAT FUNCTIONS. THE SECOND PART, LOWER, IS ORGANIC, WHICH IS CALM AND SURROUNDED BY GREENS AND IT IS DESIGNED FOR ACCOM-

THE NEXT IMPORTANT GOAL OF PROPOSAL WAS CONNECTION WITH THE SAND BERG HILL, WHICH IS MANAGED BY NATURE TRAIL. BY WHERE WE WILL GET INFO FORM A TABLES ABOUT THE AREA AND HISTICAL AND PRESERVE USE. THAT SHORT WALK, BUT WITH A SHARP SLOPE, IS FINISHED BY SMALL GALERIE, CALLED TRILODIT, WHERE WILL BE INTERESTING FINDS OF OUR AREA AND OF COURSE BEAUTIFUL PANORAMATIC VIEW. WHO WOULD NOT LIKE TO

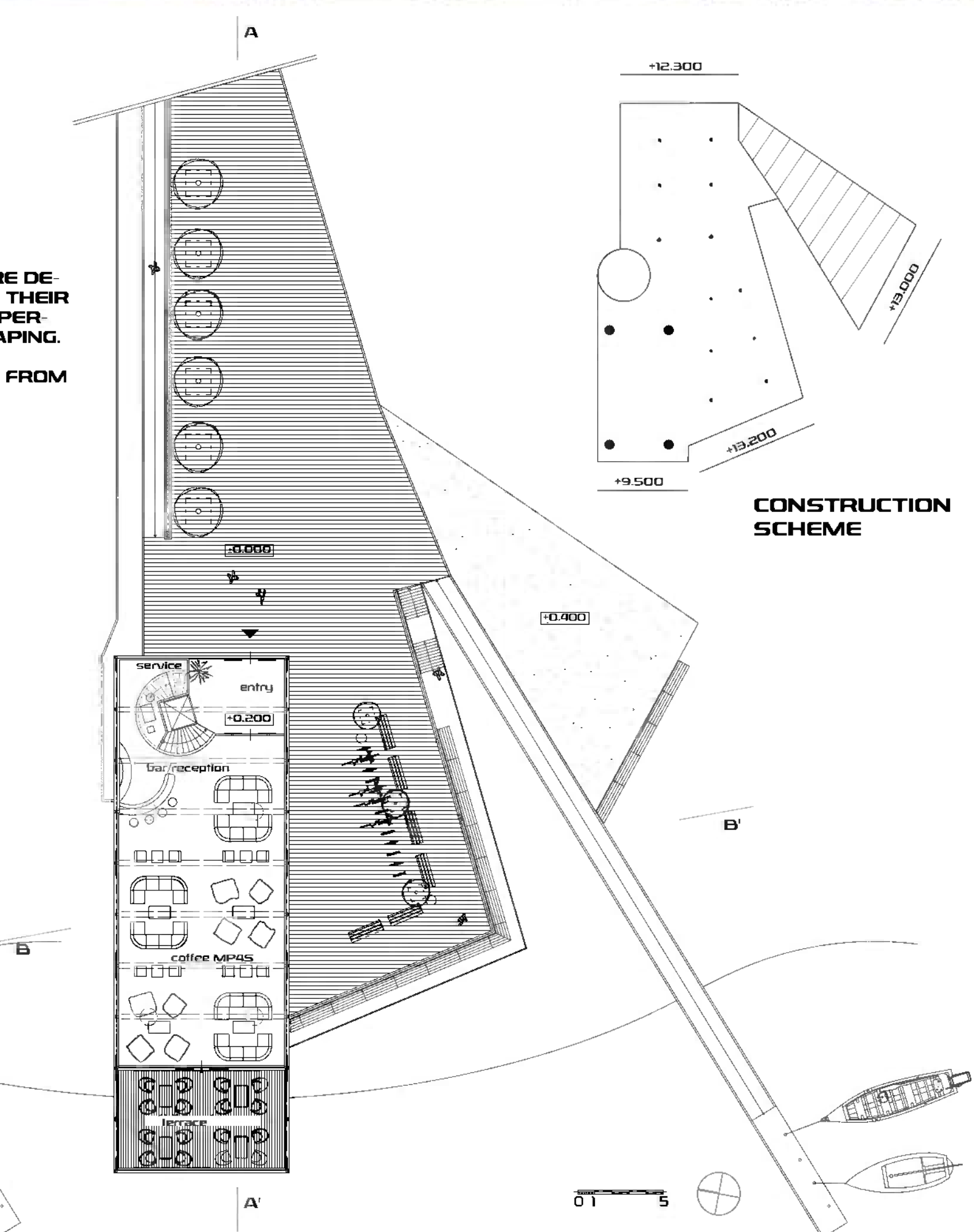
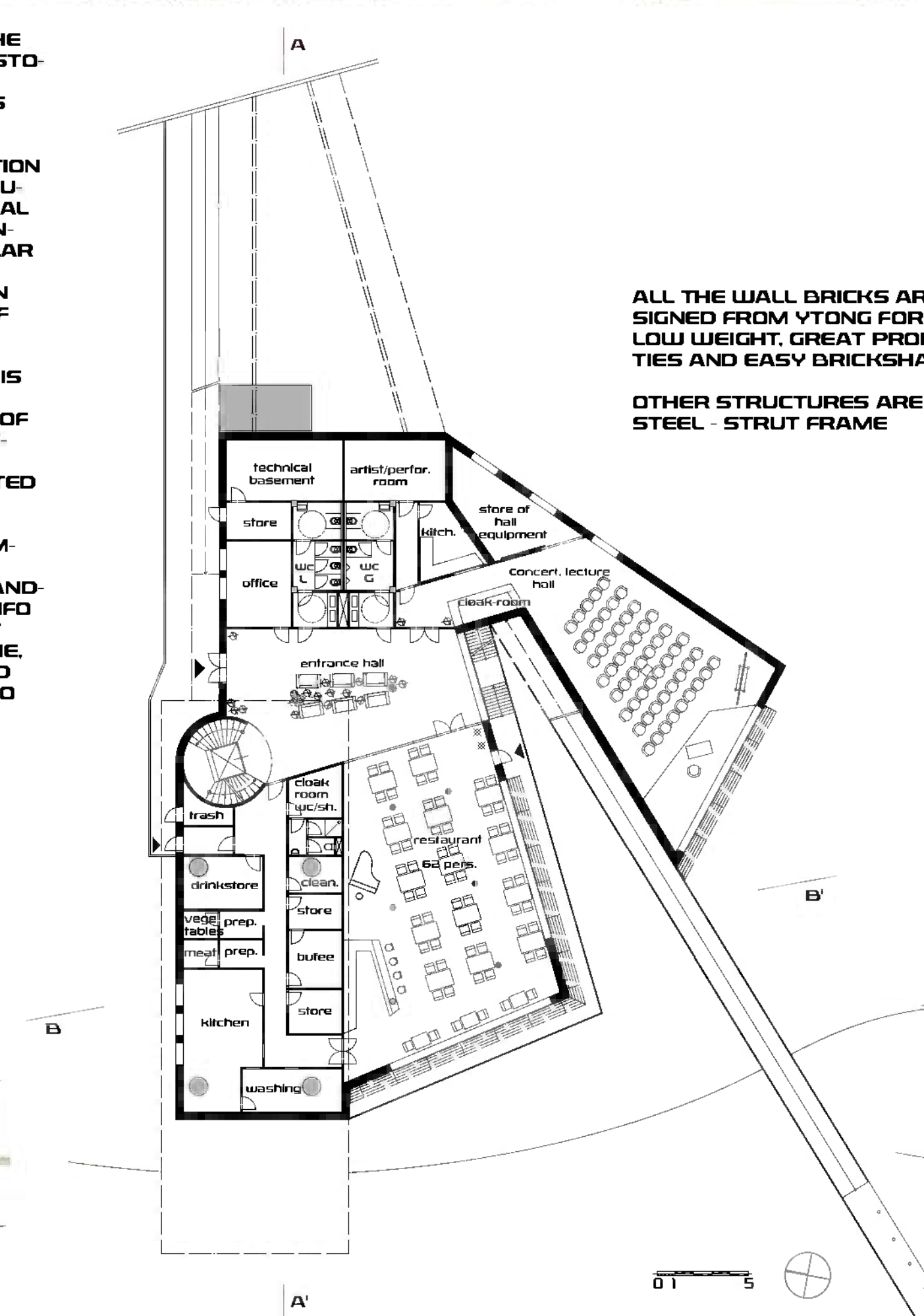

- GALERIE TRILOBIT ON THE SANDBERG
- NATURE TRAIL - CONNECTION OF FUNCTIONS
- PRESERVE AREA WITH A SPECIFIC FLORA AND HISTORICAL SECRETS - DIG OF TRILOBITES
- SANDBERG - GREAT WINDYPOINT WITH AWESOME VIEW TO LANDSPACE
- MYSTIC 4 OLD PILLONS OF THE FUNICULAR LIFT AND OTHER INDUSTRIAL POINTS
- CYCLETRACK - CONNECTION BY BIKES TO OTHER COUNTRIES IN NEAR FUTURE
- DUSSTATION
- CONNECTION BY MAIN ROAD TO DEVINŠKA NOVA VES AND DRATISLAVA
- MAIN DESIGN AREA - COFFEE, RESTAURANT, DIGITAL CONCERT AND LECTURE HALL, ACCOMMODATION
- BEAUTIFUL, CALM PLACE IN GREENS WITH A VIEW ON THE RIVER MORAVA

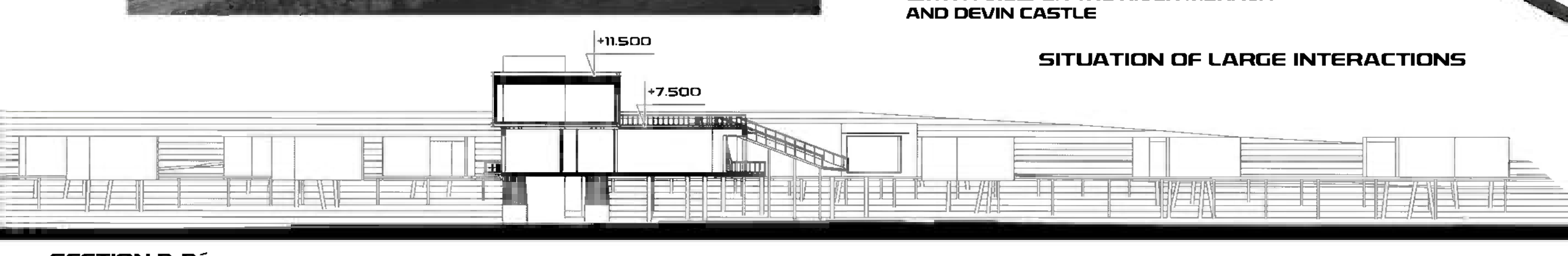

440611

