

Imagine a site of piece, spirituality and relaxation. Symbolology of cross refers to deep-rooted christian tradion in middle-european context. Once, many years ago, all the church groundplans carried its shape. Minimalisation of the church building to groundplan in our project calls for basis, fundamentals, essence. Borderline, that the cross lays at, only doubles the clash of the different powers, poles and entities. It connects, it does not separate. From the pavement passing by the river Morava bank it is possible to visit and explore the wooden bridge. Its shape of cross leads the visitors to artificial river island. We consider this island to be the place of intimacy, meditation and self-reflection. It carries the idea of the boundary, that does not separate but communicate.

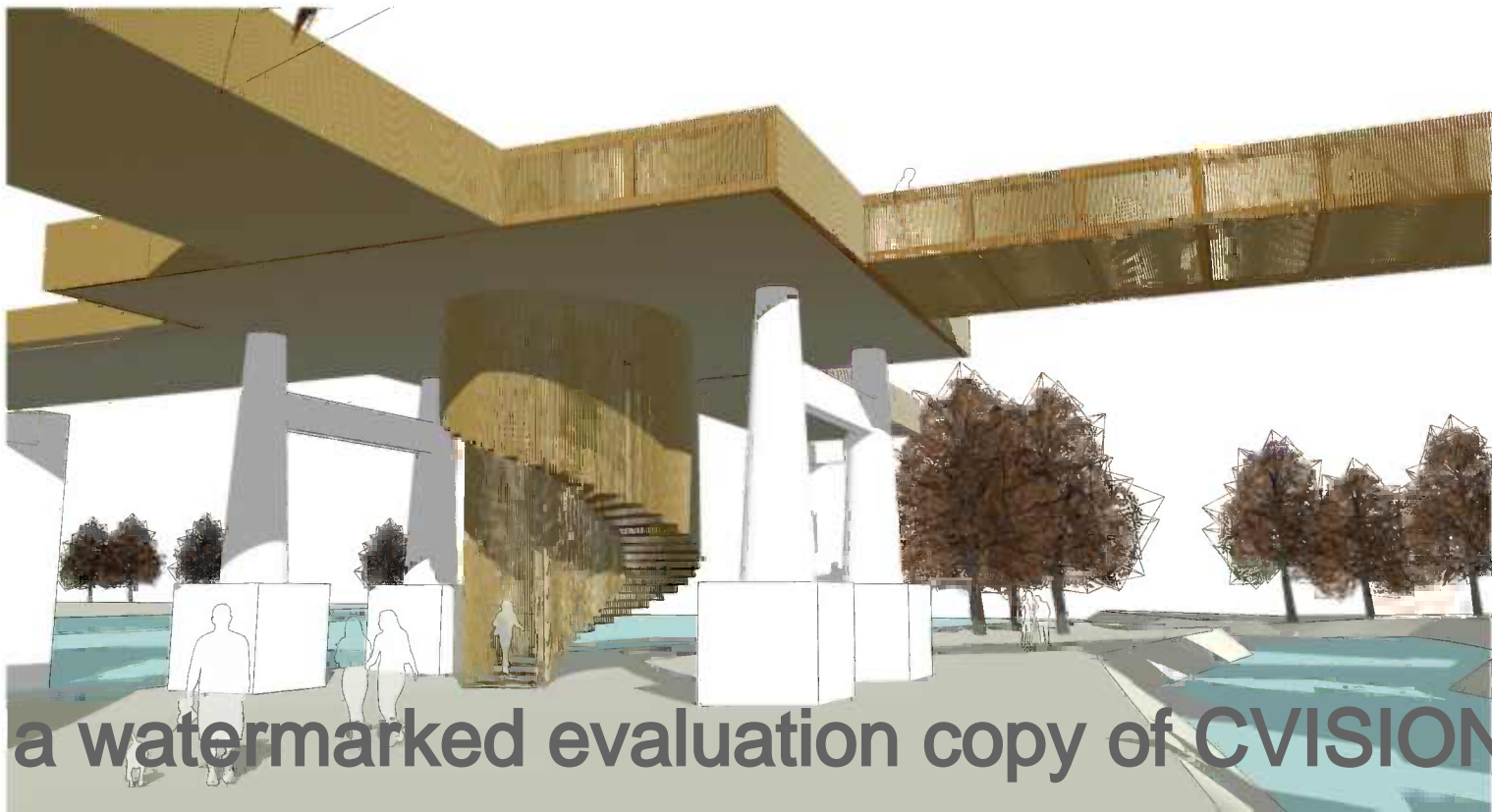

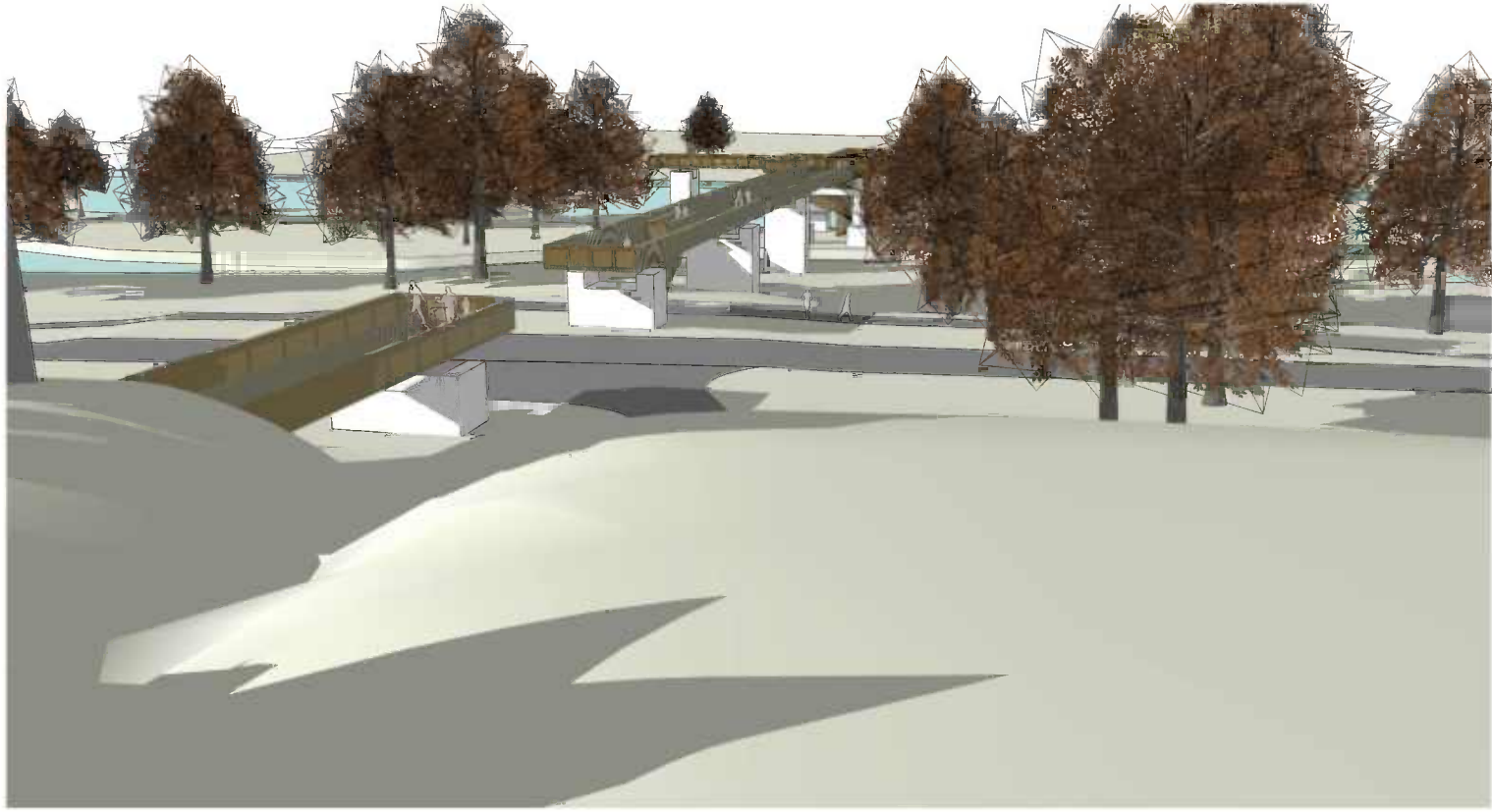

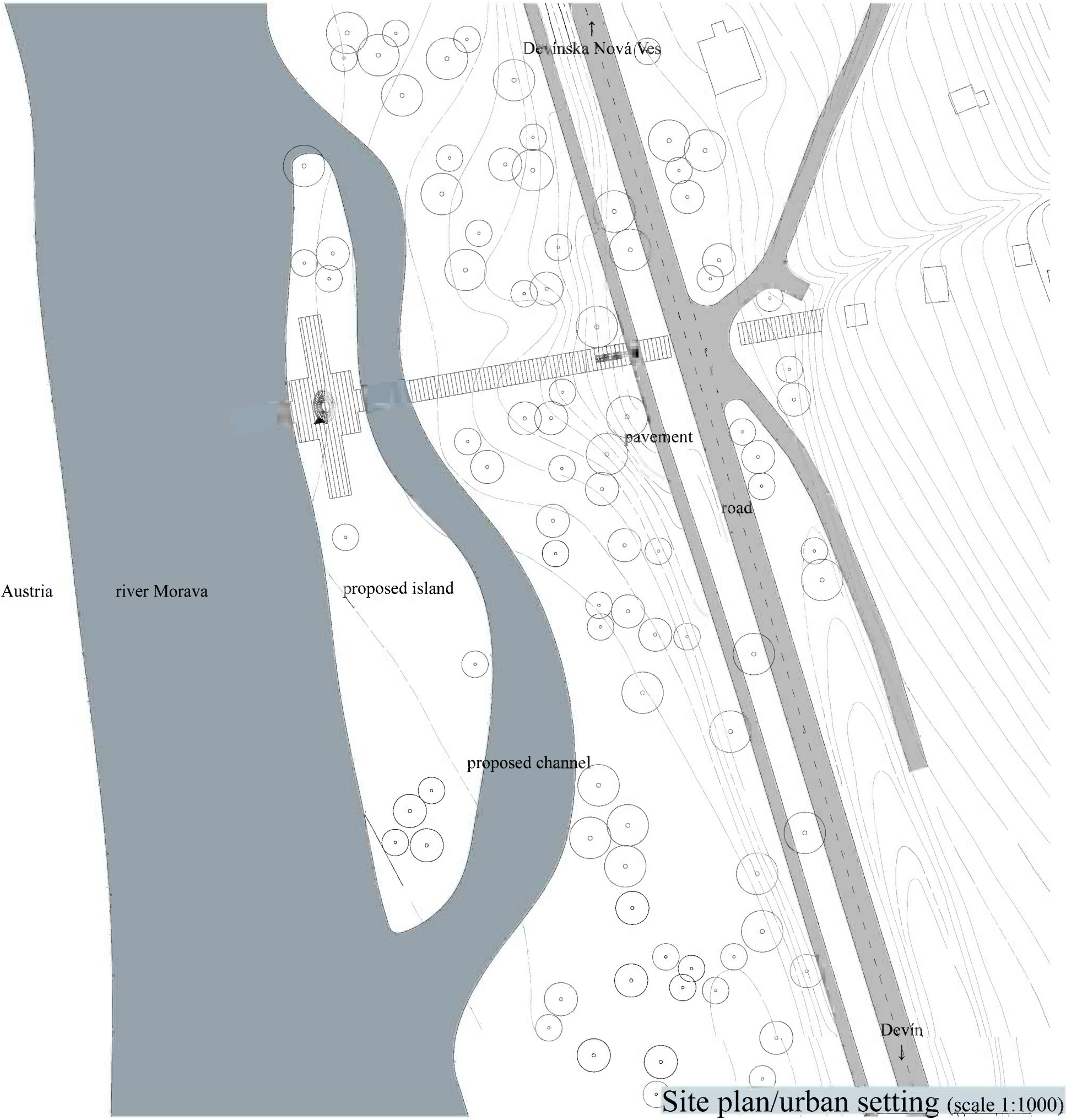
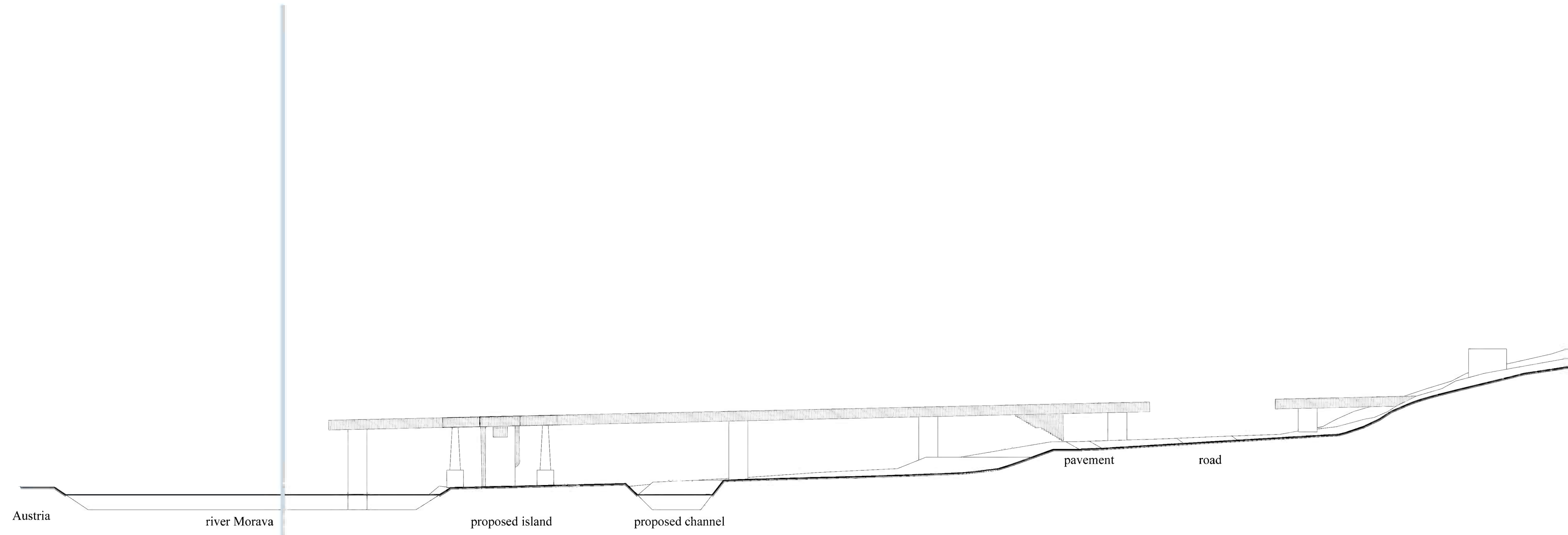

South elevation

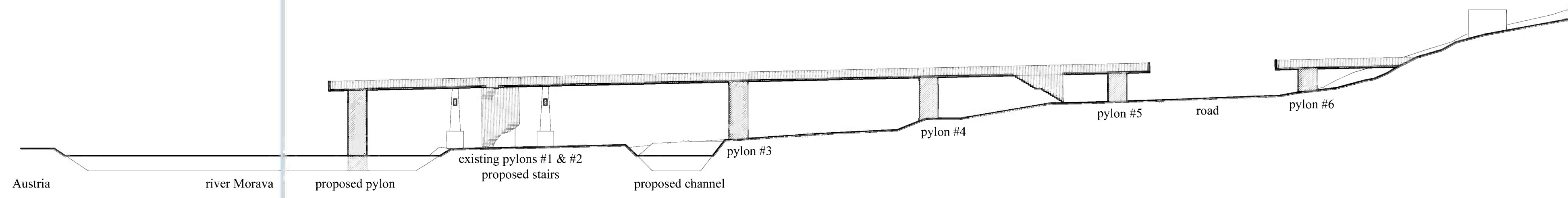

Longitudinal section

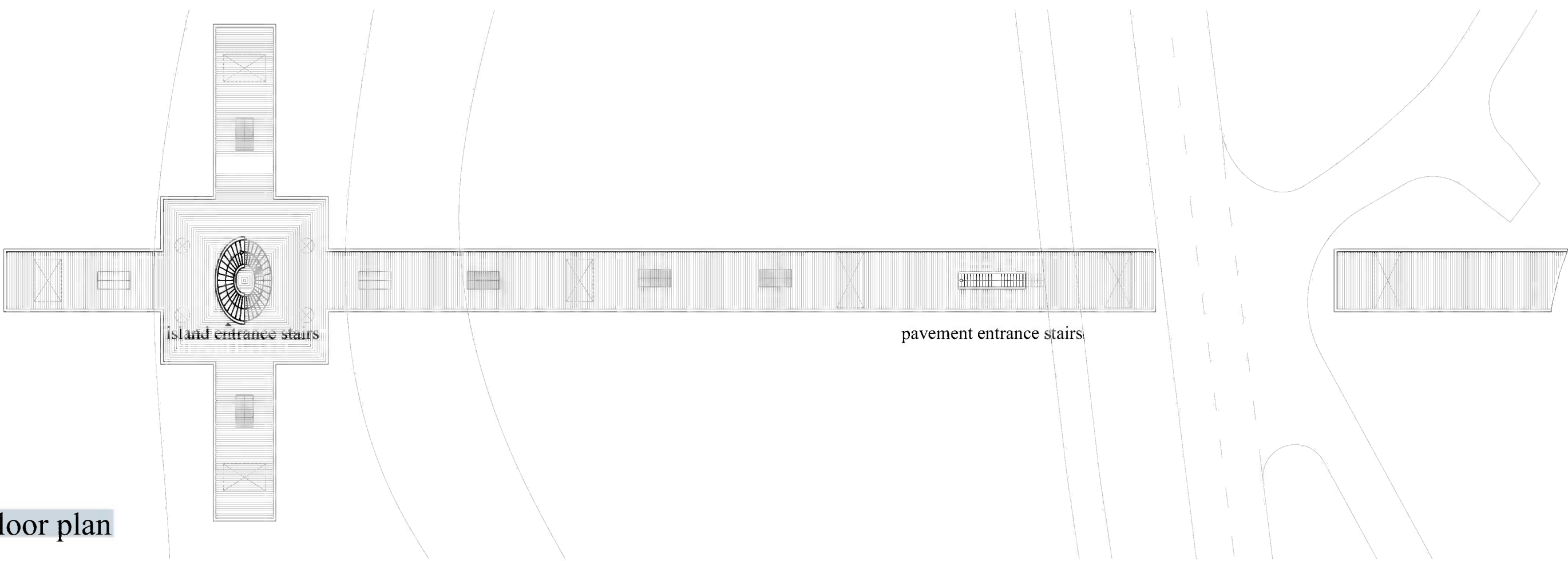

1st floor plan

