

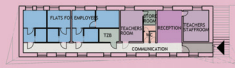

1. ENTRY TO TO THE LAND

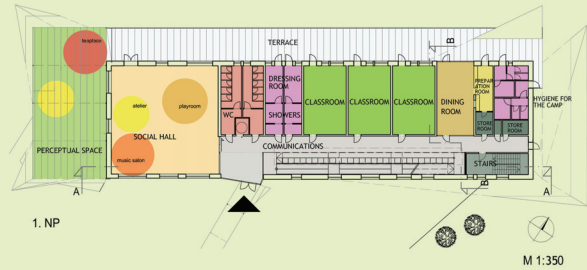

2. INFO BUILDING



3. KINDERGARTEN AND SCHOOL BUILDINGS

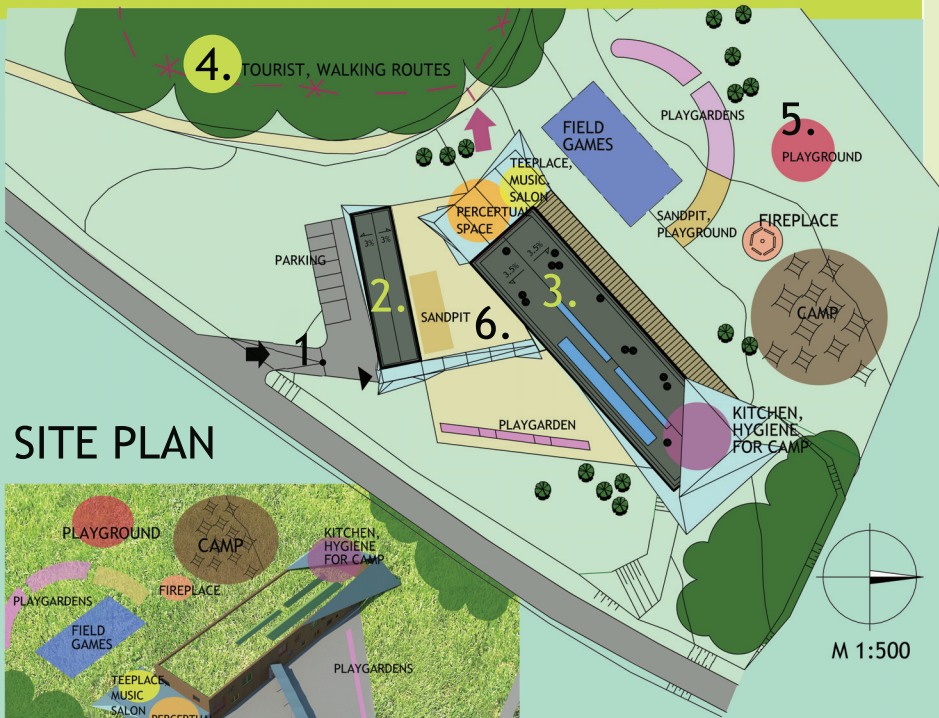

SITE PLAN

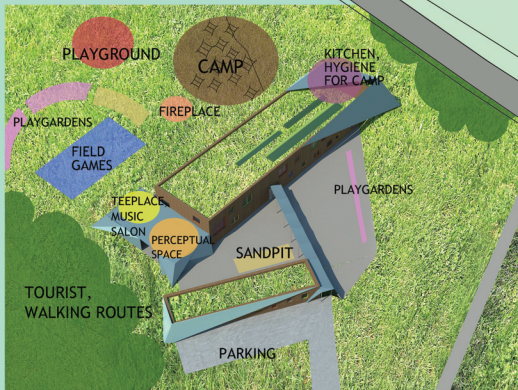

4. FOREST



5. PLAYGROUND

INTERIOR- SOCIAL HALL

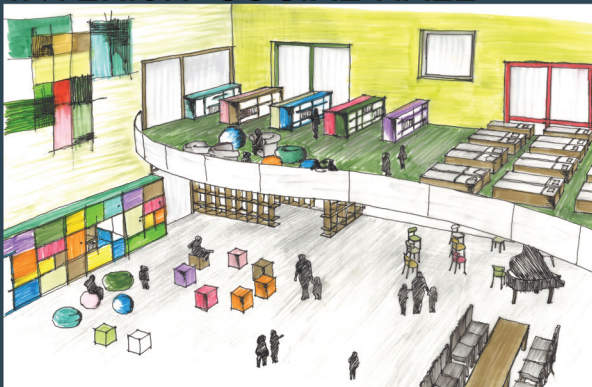

6. INTERNAL PLAYGROUND





ECOLOGICAL CONCEPT OF PD

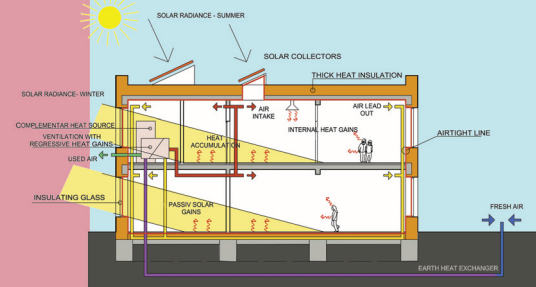

SKETCHES- PRIMAL DESIGN

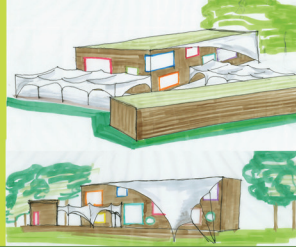

DURING CONCEPTUAL SOLUTION OF THE MASS FOREST SCHOOL AND KINDERGARTEN I CAME OUT FROM COMPACT BLOCK FORM SUITABLE ALSO FROM ECOLOGICAL VIEWPOINT. FUNCTIONALLY I DIVIDED THE MASS OF SCHOOL UP TO 2 BUILDINGS. INFO BUILDING, BACKGROUND NEAR THE ENTER INTO THE LAND AND THE PART OF CLASSROOMS AND ACCOMMODATION. THESE 2 FUNCTIONS I SITUATED INTO ONE OBJECT SO CHILDREN CAN PLAY AND LEARN TOGETHER. CHILDREN FROM SCHOOL, KINDERGARTEN OR CHILDREN WHICH ARE ACCOMMODATED HERE OR IN CAMP. TOTAL FORM OF FOREST SCHOOL I REFILLED WITH ARCHITECTURAL COMPONENTS OF TENT CONSTRUCTIONS, WHICH ARE USED AS SHELTERS, SHADED COMPONENTS. I INSPIRED BY IDEA OF CAMPING AS PART OF FOREST SCHOOL PHILOSOPHY.

ECOLOGICAL CONCEPT SOLUTION OF FOREST SCHOOL IS FOLLOWING: FRESH AIR INTAKES INTO THE OBJECT THROUGH EARTH HEAT EXCHANGER. THIS WAY PREHEATED AIR IS PIPED INTO RECUPERATION EXCHANGER, WHERE IS HEATED BY LED OUT AIR OR WITH SOLAR COLLECTORS OR HEAT EXCHANGER. FROM THIS PLACE IT IS INTAKING INTO ALL ROOMS BY COMPULSORY VENTILATION. LED OUT AIR PIPED INTO EXCHANGER, WHERE HEATS COOL AIR AND FROM THERE IT LED OUT FROM BUILDING.

FORM CONCEPT

